

## The Hawthorne Estate

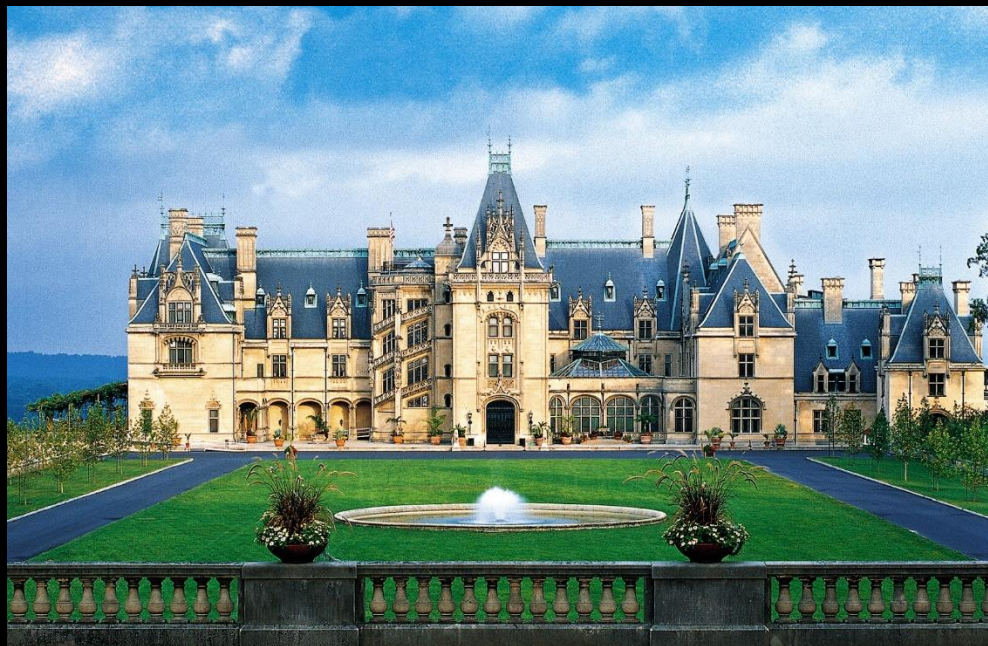

### Location:

The Estate is laid out on 200 acres of land near \_\_\_\_\_ Road.

### Description:

Hawthorne estate has four acres of floor space and a total of 250 rooms in the house including 35 bedrooms for family and guests, 43 bathrooms, 65 fireplaces, three kitchens and 19th-century novelties such as electric elevators, forced-air heating, centrally controlled clocks, fire alarms. The principal rooms of the house are located on the ground floor. To the right of the marbled Entrance Hall, the octagonal, sunken Winter Garden is surrounded by stone archways with a ceiling of architecturally sculptured wood and multifaceted glass.

### History:

The Hawthorne Estate was first brought over from England in 1865 brick by brick by the oldest son of Hawthorn family as a means to expand his family's riches through land ownership in the rich California state. He used his wealth and influence to found the city of Mayville in 1871 after which he enjoyed a brief stay as its mayor until his unfortunate death from a carriage accident in 1869. After his death the manor was made open to the public by his estate, as the gardens were famous and well known around all of California.

In 1906 it was one of a few old buildings left standing after the 1906 earthquake and fires that ravaged the now Alameda county of California. It would lay in disrepair and desolation until the late 1960's.

In 1967 the land that was once the city of Mayville was rebuilt into the modern town of Rancho Bonito, a rich sleepy little town.

The Hawthorne Estate was bought by an unknown man from Europe named Theodore Englund in 1967, the time of the building of the new town of Rancho Bonito, though never used by him as far as anyone can tell. It remained in a state of disrepair and neglect until it was purchased in 1986 by its current resident and owner, Marcus Coranovius, who spared no expense in restoring it to its previous grandness with all the modern conveniences one could wish.

The gardens were also restored to exactly as they were in late 1800s.





Gardens

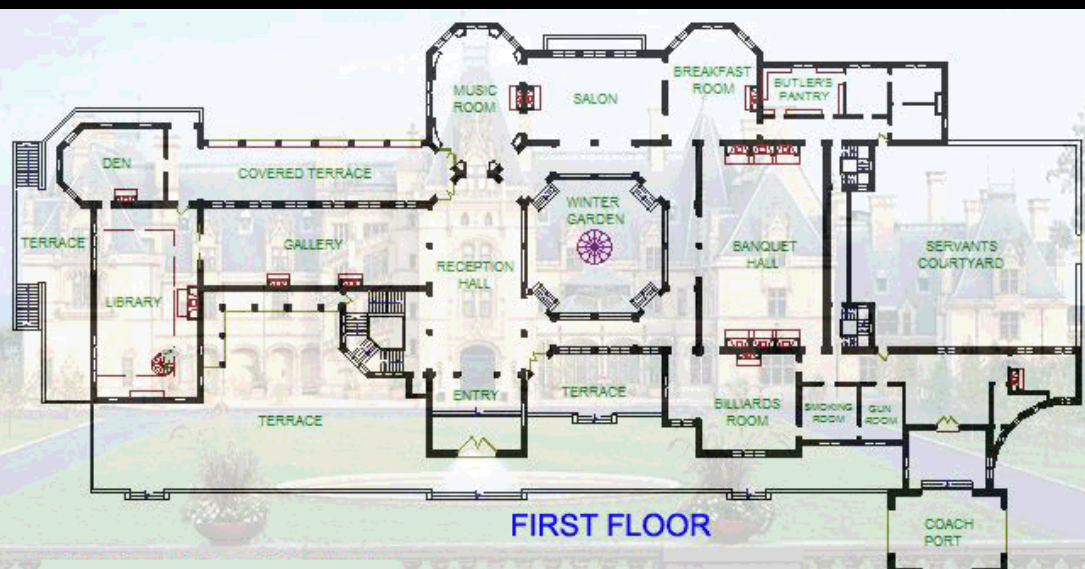

## HAWTHORNE ESTATE

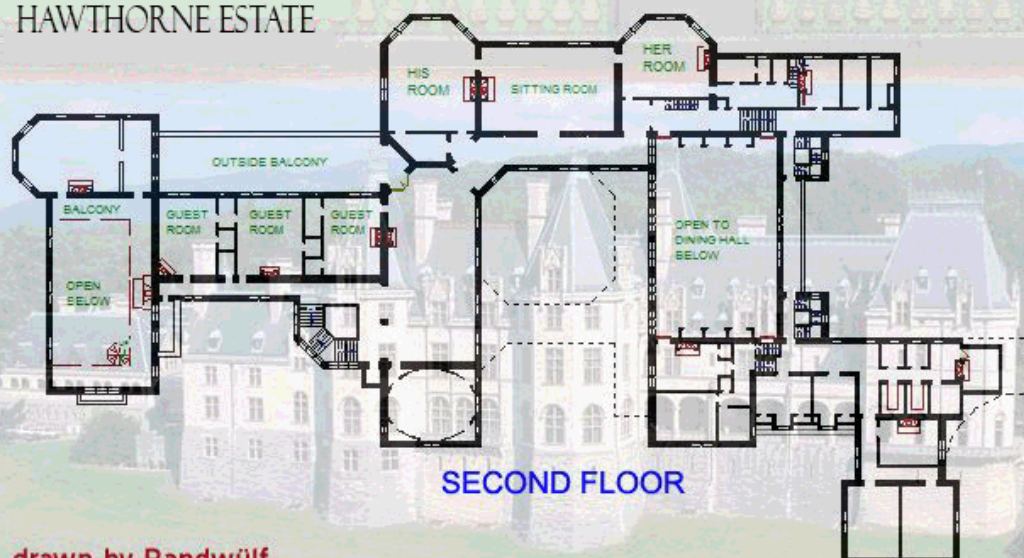

drawn by Randwulf  
[www.HogwartsCampus.com](http://www.HogwartsCampus.com)

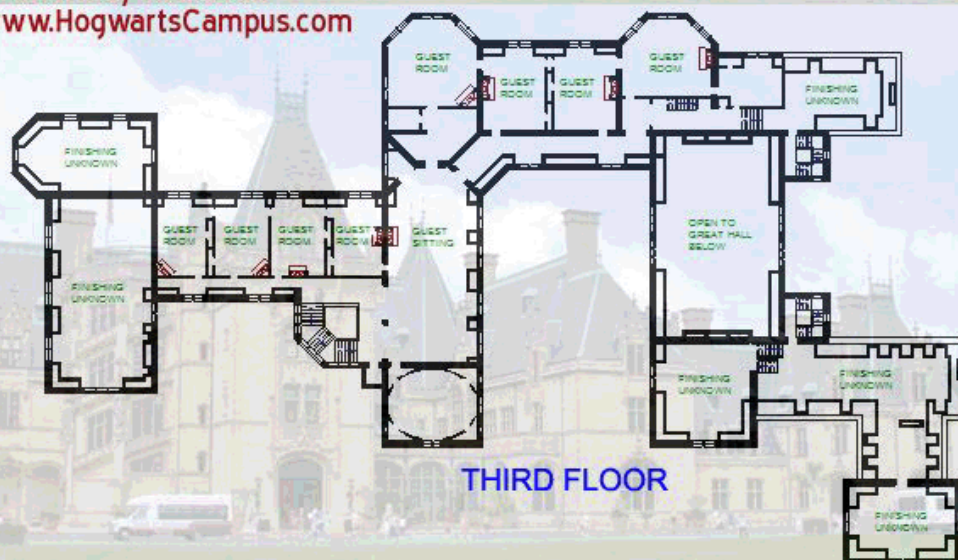

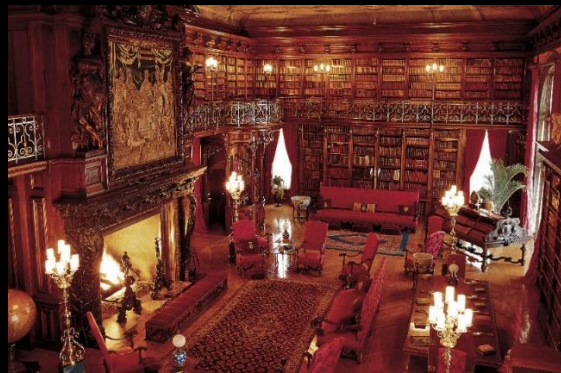

Interior Shots